

Model D9112L

Owner's Guide

This product is intended for installation by a professional installer only! Attempts to install this product by a person other than a trained professional may result in severe damage to a vehicle's electrical system and components.

Congratulations

Congratulations on the purchase of your AVITAL® system. Reading this Owner's Guide prior to using your system will help maximize the use of your system and its many features. For additional information please contact your Authorized Dealer or visit www.avital.com.

After installation is completed, you should receive:

- Two 1-Way remote controls (P/N: 7112L)
- Owner's Quick Reference Card



Important Information

Safety Information



Warning! Failure to heed the information in this guide can result in death, personal injury or property damage, and may also result in the illegal use of the system beyond its intended purpose.

Your Warranty

Your system comes with a warranty. The warranty terms are detailed at the end of this guide. Make sure that you receive proof of purchase from your dealer, indicating the product was installed by an Authorized Dealer.

Replacement Remote Controls

Please see your Authorized Dealer or visit us at www.avital.com to order additional remote controls. Remote control part numbers are found on the back of the remote.

System Maintenance

This system needs no specific maintenance beyond remote control battery replacement. See 'Battery Information' section for more details.

1-Way Remote Control



Feature	Description
Internal Antenna	Used for transmitting information.
Transmit LED	Active when transmitting information.
Command button	*Used to perform locking, unlocking, remote starting and car finder.

*Command function will vary by configuration.

Control Center

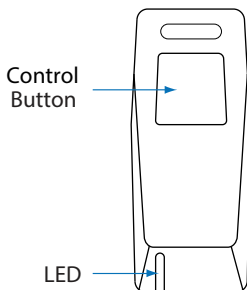

The Control Center, typically located on the upper part of the front windshield. It consists of:

- The In-vehicle system antenna, used for system and remote control communication.
- The Status LED, as a visual indicator of the system's status.
- The Control (or Valet) button, for placing the system into Garage Mode and performing various user functions.

Remote Control Command Table

There are two possible ways that your remote can control the system. Please check with your install technician to verify which functionality your remote has:

Remote Start/Unlock function: (Default)

Command	Button Press	Required System State
Start Engine	Press & Release	Engine Off
Unlock Doors	Press & Release	Remote Start ON
Car Finder	Press & Hold	Engine Off
Stop Engine	Press & Hold	Remote Start ON

***Lock/Unlock/Remote Start function:**

Command	Button Press
Lock	Press & Release One Time
Unlock	Press & Release Two Times
Start Engine	Press & Hold
Stop Engine	Press & Hold

*This configuration does not require specific systems states.

Using your System

Commands and Confirmations

Commands, Basic or Advanced, are used to activate system features and are performed by pressing one of the Command buttons. Basic commands control the most often used security and remote start features while Advanced commands control more specialized features and request reports.

Confirmations for Basic or Advanced commands are indicated first by siren chirps (when connected) and parking light flashes.

IMPORTANT:

***This Transmitter Kit is compatible with multiple system types. Each system allows varying configuration options and may not support all features and functions referred to within this guide. Check with your installer for more information about your system configuration and compatible remote control functions.**

Remote Control Functions

The remote control **REMOTE START** button is used to send commands to the system. The descriptions below reflect the default configuration for this system.

Remote Start

Press and release **REMOTE START**.

Activates the remote starter. The vehicle and parking lights turn ON.

Note: The factory setting is one press, but this can also be programmed for two presses (See your Authorized Dealer for the number of presses programmed).

Presses to activate remote start: _____.

Unlock

Press and release **REMOTE START** (while Remote Start is active). The doors unlock.

Remote Start Shutdown

Press and hold **REMOTE START** (while Remote Start is active). Deactivates the remote starter. The vehicle and parking lights turn OFF.

Car Finder

Press and hold **REMOTE START** for 3 seconds (while Remote Start is OFF). Parking lights will flash several times to help you locate your vehicle.

Alarm Features (Supported Systems)

Normal Arm

Status LED: The Control Center Status LED flashes as a visual indicator that your vehicle's security system is active.

Starter Interrupt: The starter interrupt relay prevents the engine from starting while the system is armed.

Sensor Triggers: The shock sensor can distinguish minor impacts from major impacts to the vehicle exterior. Minor impacts causes the system to emit a Warn Away output by chirping the siren and flashing the parking lights for three seconds. Major impacts caused for example by a forcible entry attempt, results in a Full Trigger output. The siren sounds and the parking lights flash for 30 seconds or longer.

Point of Entry Triggers: Opening the hood or trunk causes a Full Trigger output, while opening a Door or turning on the Ignition causes the siren to chirp three seconds before beginning the Full Trigger output. This three second delay allows time to disarm and silence the siren in case of accidental trigger.

Sensor Warn Away

When the system sensors detect a Warn Away trigger, the siren chirps and parking lights flash for three seconds.

Full Trigger

An alarm Full Trigger will sound the siren and flash the parking lights for 30-seconds and siren tones play for 30-seconds.

Emergency Override

The following procedure disarms the system when a programmed remote is not available. Number of presses _____.

1. Turn the ignition ON.
2. Press the Control Center button the correct number of times (the default is one press).

After a few seconds the siren output ceases, and the system is disarmed.

Note: As a precaution, if programmed for 'Passive Arming' or 'Auto Re-Arming' the system should be placed into Valet Mode until a remote is available.

Trigger Zone Fault Report

When armed by remote command the system runs a status check of the alarm trigger zones. Faulty zones (usually caused by dome light delay or open trunk) are bypassed and reported via the control center LED and remote, while all other trigger zones remain active and are monitored to protect the vehicle. Should a faulty zone self-correct (dome light turns off) it becomes active and is then monitored normally. The siren chirps once again a few seconds following the arming chirps as an audible alert, the Control Center LED flashes in groups to indicate the zone number.

Alarm Report

If the alarm was triggered while armed, it will be reported when the system is disarmed. The siren chirps four times (or five times if NPC ON), the parking lights flash three times, and the control center LED flashes in groups to indicate the last two zones that were triggered (see Table of Zones). The report output will repeat for each disarm operation until the ignition is turned ON.

Table of Zones	
Zone # (led flashes)	Zone Name
1	Trunk
2	Shock Sensor
3	Door
4	Sensor 2 / Instant trigger / Tilt
5	Ignition
6	Hood
7	Other Sensor (DS4 Only)

NPC (Nuisance Prevention Circuitry)

NPC monitors all alarm zones. If any zones are triggered excessively, NPC bypasses them until corrected. If a point of entry (trunk, hood, door) is left open following a forced entry, it is bypassed. It becomes active again only after being closed.

Note: Bypassed sensors automatically reset after one hour and after the Ignition is cycled. Disarming, then re-arming the alarm does not reset bypassed sensors.

Passive Arming*

Park and exit the vehicle, after the doors are closed the Passive arming countdown begins. The led flashes quickly and upon reaching 20-seconds the siren then chirps once. At 30-seconds the system arms itself. Any time before the system arms you can re-enter the vehicle or open the trunk to load or unload items and, after closing passive arming resumes. If a door is not opened within 30-seconds the system re-arms itself and locks the doors.

Auto Re-arming*

Auto re-arm ensures the vehicle stays protected if it is not entered after disarming by remote control. After disarming by remote, the alarm automatically re-arms itself (and locks the doors if programmed on) in 30 seconds. Open any point of entry to stop the re-arm until the next disarm by remote.

One-time Bypass*

Turn the ignition on for one to three seconds, and then off. The siren chirps once to confirm one-time bypass is enabled.

One-time bypass can be used to temporarily bypass the Passive Arming operation for one cycle. After the next disarm all operations return to normal.

*These features must be turned on by an Authorized Dealer.

Remote Start Features (Supported Systems)

Key Takeover

While remote started, 'Key Takeover' must be completed to keep the engine running while the vehicle transitions from Remote start to normal Key operation.

To perform Key Takeover:

1. Disarm the system and enter the vehicle (Do not step on the foot brake).
2. Turn the ignition ON.
3. Step on the foot brake.

The remote start then turns off and vehicle remains running. The parking lights turn off to indicate remote start is OFF, and then after a few seconds the remote plays the Remote Start OFF message. The vehicle is ready to drive.

Note: The 'Key Takeover' procedure may vary by vehicle and installation. Some Push-to-Start vehicles do not allow the key takeover feature, check with your installer for more details.

Garage Mode (Remote Start Valet) (DS3/DS4 Systems)

Disabling the Remote Start System/Garage Mode

Garage Mode is a safety feature that disables the remote start system if the vehicle is parked in a garage, being serviced, or used by someone unfamiliar with remote start systems.

When Garage Mode is ON, any attempt to start the engine, activate Timer Mode, or enter Pit Stop mode is denied and remote start diagnostics flashes the parking lights nine times.

Turn Garage Mode ON or OFF:

1. Turn the ignition ON then OFF.
2. Within 10 seconds, press and hold the Control Center button for 5-seconds.
3. The Control Center LED turns on.

The parking lights flash:

- Nine times quickly when turning on.
- Nine times slowly when turning off.

Garage Mode (DB3/RSR Systems)

Turn Garage Mode ON or OFF:

This must be done by manually positioning the installed Valet toggle switch ON or OFF. Ask your installer for additional information. The Valet switch is located:_____.

Pit Stop Mode

Pit Stop mode keeps the engine running during short trips into the house or convenience store.

To perform Pit Stop:

1. With the engine running, and vehicle in PARK. Set the parking brake. Do not press the foot brake at any time.
2. Press the **REMOTE START** button. The parking lights will turn on to confirm Pit Stop is active.
3. Turn the ignition OFF.
Exit the vehicle and arm the alarm.
The engine continues running for the programmed runtime.

Note: Pit Stop Mode procedure may vary by vehicle and installation. Check with your installer for more details.

MTS Mode (Manual Transmission Start)

When installed into a manual transmission vehicle, the system requires that the MTS Mode is properly set when parking. If MTS Mode is not properly set, or is disabled after being properly set, the system will not start the vehicle.

To set MTS:

1. With the engine running, place gear shifter in neutral position.
2. Press and hold the foot brake (do not release).
3. Set the parking brake and leave the engine running.
4. Release the foot brake.
5. Within 20-seconds of foot brake release, press the **REMOTE START** button on the remote (after 20 seconds return to Step 2).

The parking lights flash several times to confirm MTS mode is set.

6. Turn the ignition OFF (engine remains running).
7. Exit the vehicle and close all the doors.
8. Arm the system.

The engine turns off.

Note: MTS Mode procedure may vary by vehicle and installation. Check with your installer for more details.

Turbo Timer Mode

'Turbo Timer Mode' keeps the engine running for a short duration when the ignition is turned OFF. This function can be activated by remote control or optional dash mounted activation button.

To activate Turbo Timer:

1. With the engine running, set the parking brake.
2. Press the optional dash mounted activation button or perform the Timer Mode command.

The parking lights turn on and the remote start activates.

3. Turn the ignition OFF (engine remains running).
4. Exit the vehicle and close all the doors.
5. Arm the system.

The engine runs for the duration of Turbo Mode runtime.

Note: Turbo Timer and Turbo Timer runtime must be configured by an Authorized Dealer.

Note: For Turbo Timer Mode on manual transmission vehicles follow the directions in the MTS Mode (Manual Transmission Start) section with the door open in step 3, press the optional dash mounted activation button or send the Timer Mode command from the remote control.

Remote Start Faults

For user safety, the system must be properly configured, and the vehicle must meet several conditions, or the remote start will not activate. Ensure that all point of entry zones are closed and that the alarm has not been triggered. If remote start commands continue to fail, see your Authorized Dealer.

System Features (Supported Systems)

Power Save

To reduce power consumption the Control Center status LED modifies its output if the vehicle is parked for an extended period. If Armed the flashing is reduced after 24 hours.

When Valet Mode is ON, the LED turns off after one hour and resets each time the ignition is turned off.

Rapid Resume

If power is ever disconnected by a mechanic or thief, the system will resume the state it was in at the time of disconnection, when power is reconnected.

System Expansion Options

Owner Recognition*

The system can be configured to recognize the remote used when disarming and change selected features to match the remote users' preferences. This may include siren chirps, passive arming, remote button auto unlocking, alarm output duration can all be custom set for each remote user at the time of installation.

Comfort Closure*

Comfort Closure emulates turning the key in the door cylinder or holding the lock button of an OEM keyless entry. It will automatically close the windows and sunroof on vehicles with this type of OEM convenience feature.

Siren Output Duration*

The length of time the siren sounds can be adjusted from 1 to 180 seconds at the time of installation.

Arming and Warn Away Chirp Control*

The system Arm, Disarm and Sensor Warn Away chirps can be configured for those that prefer a custom silent alarm operation.

Driver Door Priority Unlocking*

The door unlocking operation can be configured to emulate an OEM style of driver priority unlocking for added security during disarming.

*Note: These features are not compatible with all vehicles. Additional parts and labor may be required and will vary by vehicle and installation. Check with your installer for more details.

Remote Start



Warning! Safety First

Please read the safety warnings below before proceeding. Improper use of the product may be dangerous or illegal.

Installation

Due to the complexity of this system, installation of this product must only be performed by an Authorized Dealer. If you have any questions, ask your Authorized Dealer or contact Customer Service at 1-800-753-0600.

Remote Start Notice

When properly installed, this system can start the vehicle via a command signal from the remote control transmitter. Therefore, never operate the system in an enclosed area or partially enclosed area without ventilation (such as a garage). When parking in an enclosed or partially enclosed area or when having the vehicle serviced, the remote start system must be disabled using 'Garage Mode'. It is the user's sole responsibility to properly handle and keep out of reach from children all remote control transmitters to assure that the system does not unintentionally remote start the vehicle. THE USER MUST INSTALL A CARBON MONOXIDE DETECTOR IN OR ABOUT THE LIVING AREA ADJACENT TO THE VEHICLE. ALL DOORS LEADING FROM ADJACENT LIVING AREAS TO THE ENCLOSED OR PARTIALLY ENCLOSED VEHICLE STORAGE AREA MUST AT ALL TIMES REMAIN CLOSED.

These precautions are the sole responsibility of the user.

Manual Transmission Notice

Remote starters on manual transmission vehicles operate differently than those with automatic transmission and operation will vary by vehicle and system configuration. Ask your Authorized Dealer for proper procedures regarding manual transmission configuration and activation prior to use.

Before remote starting a manual transmission vehicle, be sure to:

- Leave the vehicle in neutral and be sure no one is standing in front or behind the vehicle.
- Only remote start on a flat surface.
- Have the parking brake fully engaged.

WARNING! It is the responsibility of the owner to ensure the parking/emergency brake properly functions. Failure to do so can result in personal injury or property damage. We recommend the owner have the parking/emergency brake system inspected and adjusted by a qualified automotive shop biannually.

Use of this product in a manner contrary to its intended mode of operation may result in property damage, personal injury, or death. (1) Never remotely start the vehicle with the vehicle in gear, and (2) Never remotely start the vehicle with the keys in the ignition. The user must also have the neutral safety feature of the vehicle periodically checked, wherein the vehicle must not remotely start while the car is in gear.

This testing should be performed by an Authorized Dealer in accordance with the Safety Check outlined in the product installation guide. If the vehicle starts in gear, cease remote start operation immediately and consult with an Authorized Dealer.

OPERATION OF THE REMOTE START MODULE IF THE VEHICLE STARTS IN GEAR IS CONTRARY TO ITS INTENDED MODE OF OPERATION.

OPERATING THE REMOTE START SYSTEM UNDER THESE CONDITIONS MAY RESULT IN PROPERTY DAMAGE OR PERSONAL INJURY. YOU MUST IMMEDIATELY CEASE THE USE OF THE UNIT AND SEEK THE ASSISTANCE OF AN AUTHORIZED DEALER TO REPAIR OR DISCONNECT THE INSTALLED REMOTE START MODULE. DIRECTED by VOXX LLC WILL NOT BE HELD RESPONSIBLE OR PAY FOR INSTALLATION OR REINSTALLATION COSTS.

This product is designed for fuel injected vehicles only. Use of this product in a Manual Transmission vehicle must be in strict accordance with this guide. This product should not be installed in any convertible vehicles (soft or hard top), with a manual transmission. Installation in such vehicles may pose certain risk.

Upgrades

Upgrades must be performed by an Authorized Dealer. Do not perform any unauthorized modifications to this product.

Battery Information

When the remote control battery begins to weaken, the operating range will be reduced.

Battery Replacement:

If communication range is diminished, or the remote control ceases to function, the remote battery should be replaced. It is recommended to have your battery replaced by an Authorized Dealer. To gain access to the battery, the rear case will need to be separated from the transmitter. In some cases, remotes may have a small security screw(s) that needs to be removed prior to separating.

Note: USB-Rechargeable remote control batteries are not intended to be replaced. If your remote fails to charge, contact your Authorized Dealer.

IMPORTANT: Improper remote disassembly may result in injury or damage to the remote and or battery.

Battery Disposal



We care about the environment. If you need to dispose of the battery, please do so in accordance with your local municipal requirements for battery disposal.

Patent Information

This product may be covered by one or more of the patents found on our website. For a full list of patents, please visit: www.voxxintl.com/company/patents

Government Regulations

FCC Compliance

This device complies with Part 15 of the FCC rules and with RSS-210 of Industry Canada. Operation is subject to the following two conditions:

1. This device may not cause harmful interference, and
2. This device must accept any interference received, including any interference that may cause undesired operation.

Warning!

Changes or modifications not expressly approved by the party responsible for compliance could void the user's authority to operate the equipment.

Warranty Information



LIMITED LIFETIME WARRANTY

DIRECTED by VOXX LLC (the Company) warrants to the original purchaser of this product that should this product or any part thereof, under normal use and conditions, be proven defective in material or workmanship within the Lifetime from the date of original purchase in the original vehicle, such defect(s) will be repaired or replaced with new or reconditioned product, (at the Company's option) without charge for parts or repair labor. A transmitter for a vehicle security or remote start system is warranted for 12 months from the date of original purchase.

To obtain repair or replacement within the terms of this Warranty, the product is to be delivered with proof of warranty coverage (e.g. dated bill of sale), authorization number, specification of defect(s), transportation prepaid, to an approved warranty station. This warranty is not transferable.

This Warranty does not cover damage to the vehicle's electrical system or costs incurred for the installation, removal or reinstallation of the product. This Warranty does not cover batteries, broken LCD transmitter display screens, nor apply to any product or part thereof which, in the opinion of the Company, has suffered or been damaged through alteration, improper installation, mishandling, misuse, abuse, neglect, accident, or by removal or defacement of the factory serial number/bar code label(s).

This Warranty is in lieu of all other express warranties or liabilities. ANY IMPLIED WARRANTIES, INCLUDING ANY IMPLIED WARRANTY OF MERCHANTABILITY, SHALL BE LIMITED TO THE DURATION OF THIS WRITTEN WARRANTY. ANY ACTION FOR BREACH OF ANY WARRANTY HEREUNDER INCLUDING ANY IMPLIED WARRANTY OF MERCHANTABILITY MUST BE BROUGHT WITHIN A PERIOD OF 24 MONTHS FROM DATE OF ORIGINAL PURCHASE. IN NO CASE SHALL THE COMPANY BE LIABLE FOR ANY CONSEQUENTIAL OR INCIDENTAL DAMAGES FOR BREACH OF THIS OR ANY OTHER WARRANTY. No person or representative is authorized to assume for the Company any liability other than expressed herein in connection with the sale of this product.

The company does not warrant that this product cannot be compromised or circumvented. THE EXTENT OF THE COMPANY'S LIABILITY UNDER THIS WARRANTY IS LIMITED TO THE REPAIR OR REPLACEMENT PROVIDED ABOVE AND, IN NO EVENT, SHALL THE COMPANY'S LIABILITY EXCEED THE PURCHASE PRICE PAID BY PURCHASER FOR THE PRODUCT WITHOUT INSTALLATION LABOR.

Some states do not allow limitations on how long an implied warranty lasts or the exclusion or limitation of incidental or consequential damage so the above limitations or exclusions may not apply to you. This Warranty gives you specific legal rights and you may also have other rights which vary from state to state.

DIRECTED by VOXX LLC, 2351 J. Lawson Blvd., Orlando, Florida 32824